



# Kentlake High School Kent, WA

**PROGRAM:** The new Kentlake Senior High School was conceived through a comprehensive planning effort involving students, teachers, parents, community members, senior citizens and the architectural design team. The planning team addressed various activities involved in the learning process of high school students. This collaborative planning effort addressed innovative solutions reflecting the most current knowledge about how we learn, along with community and cultural influences that affect the use of a high school facility.



Picture and story courtesy BLRB, Tacoma, WA

The performing arts auditorium is divisible into three teaching stations by the use of revolving turntables. In the open position the auditorium can seat 600 students.

When closed, each turntable can provide a lecture-type space for up to 125 students.

This concept adds maximum flexibility to the auditorium for educational/academic use. Completing the performing arts area is a band and choral room along with a small drama theater with dressing rooms.

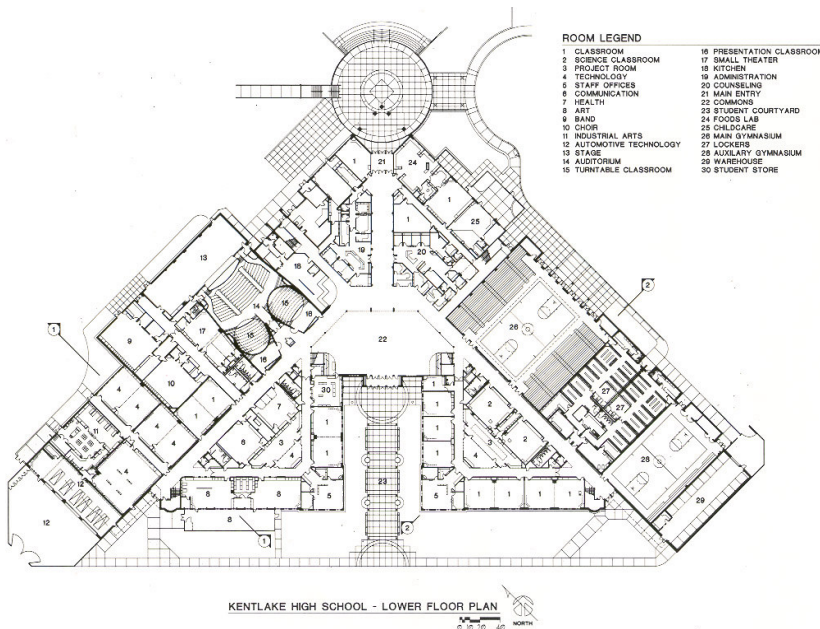

- 1999 Polished Apple Award - CEFPI
- 1997 Polished Apple Award - CEFPI
- Citation Award - AASA
- Educational Design Excellence (Auditorium/Music rooms) - Educational Interiors Showcase - AS&U
- Exhibition - Educational Interiors Showcase - AS&U
- Excellence in Masonry - MIW